

PASSWORD MANAGER > AUTOFILL >

# Autosave From Browser Extensions

View in the help center:

<https://bitwarden.com/help/autosave-from-browser-extensions/>

## Autosave From Browser Extensions

Bitwarden browser extensions offer an array of in-browser notifications that compare your decrypted data with data that you enter into login, registration, and similar web forms. This includes:

- A notification to save or use passkeys.
- A notification to add an undetected login.
- A notification to update an existing login.

These notifications are active by default, but can be turned off from the browser extension's **Settings → Notifications** menu.



### Tip

You can also block specific sites from triggering autosave notifications from the **Settings → Notification → Excluded domains** menu. Learn more in [Block Autosave on Specific Sites](#).

## Ask to save and use passkeys

When Bitwarden detects that you're creating a new passkey for a website, or if you're being prompted to login with a passkey that you have saved in Bitwarden, Bitwarden will prompt you to either save a new passkey or log in with an already-saved one:

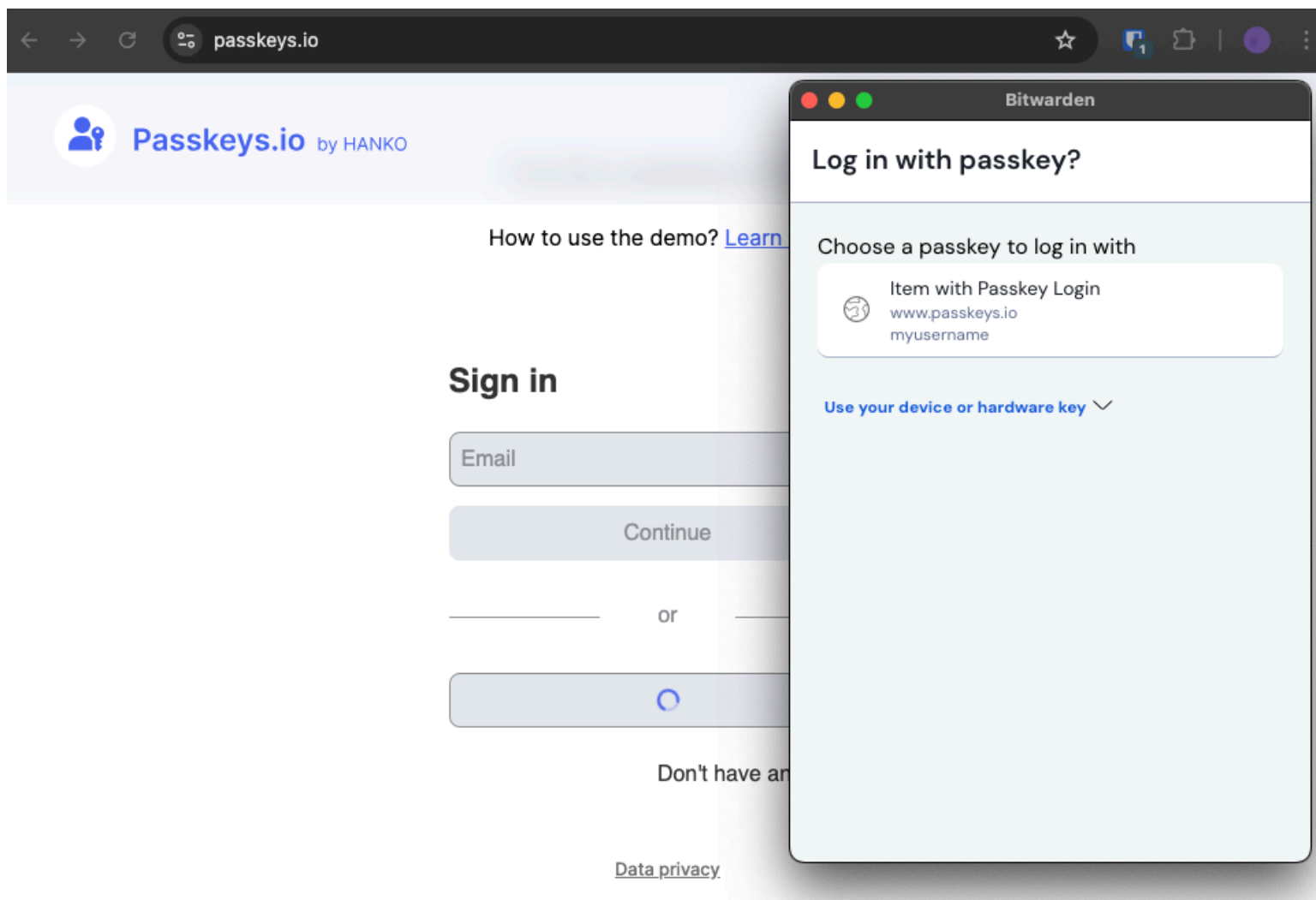

Log in with passkey

More information can be found in [Autofill Passkeys](#).

## Ask to add login

When Bitwarden detects that you've entered login information for a page that isn't stored in Bitwarden, you'll be prompted to save those credentials in Bitwarden:



Ask to add login

From this notification, you can select whether to store this among your personal items (i.e. **My vault**) or with an organization. You can also edit the item before saving it using the edit  button.

## Ask to update existing login

When Bitwarden detects that login information you enter on a form for an item you have saved in Bitwarden is different from what you have saved, for example if you've recently updated your password on a website but not in Bitwarden, you'll be prompted to update your credentials in Bitwarden:

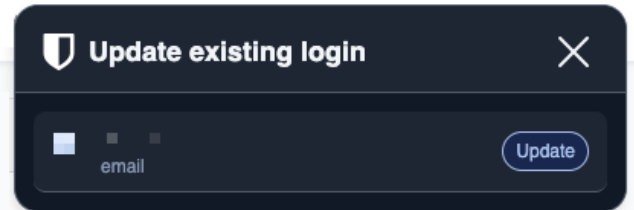

Ask to update existing login